

Talavera Close

OLD MARKET

APPROXIMATE FLOOR AREA
65 SQM / 700 SQFT

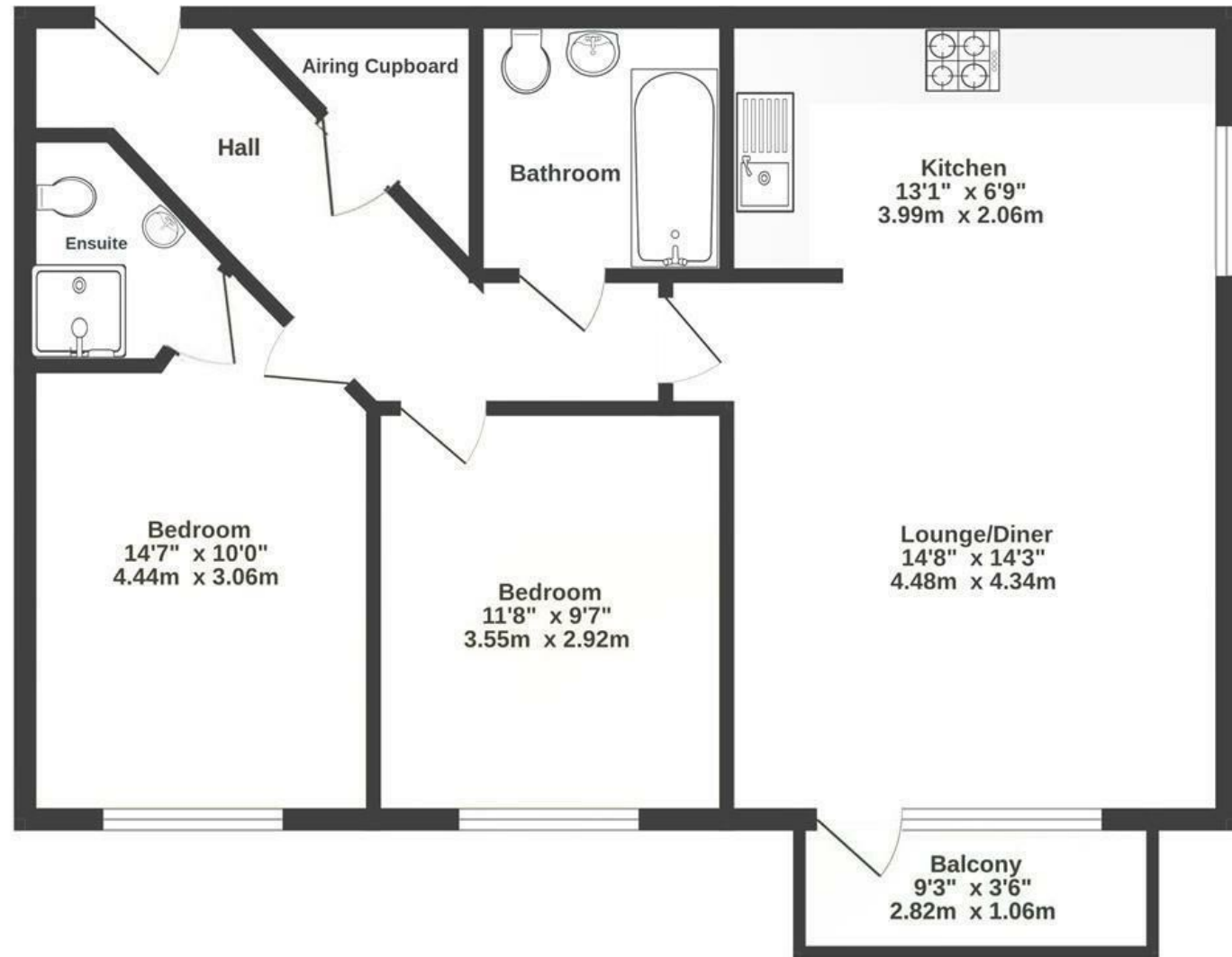

Boardwalk

Talavera Close

OLD MARKET, BRISTOL

£

£285,000

zzz

2 Bedrooms



BS2 0ED



2 Bathrooms

"We love having drinks on the balcony watching the sun go down and waking up to the smell of cinnamon from the bakery. We feel so lucky to have the cycle path on our doorstep, as well as many excellent local brewpubs and restaurants (especially the Barley Mow and Gigi's Pizza!). The large kitchen-living room has been ideal for hosting dinners and games nights – you can really fit a lot of people in! On a quieter night, it feels warm and cosy too."

